

Single Walled Flue System <SKS-X>

Single Walled Flue System <SKS-X> is single walled chimney duct made of stainless steel 1.4301 acc. to DIN17441. IT is used to exhaust fumes from modern condensing boilers which use the effect of water vapour condensation in the combustion process or from "Turbo" type of boilers with closed combustion chamber, that use a ventilator to exhaust fumes (positive pressure chimney duct) as well as stoves for pellets. In this system, air necessary for combustion process is taken directly from the boiler room or from outside with the usage of a separate pipe. This system secure inner surface of ceramic chimney ducts from destructive influence of chemical substances which are part of the fumes.

Maximum working temperature: 250°C.

Single walled flue system <SKS-X> allows old, existing chimney ducts to be used with new and modern type of boilers.

Certificate of Factory Production Control 1450-CPD-0030 issued by INiG Cracow.

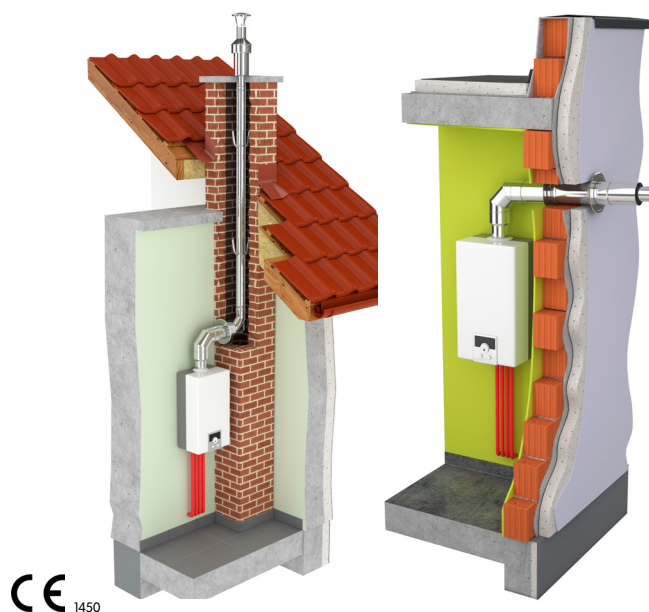

Application of chimneys and recommended sheet thickness

Diameter DN	S, D* 1.4301
60	0.4
80	0.4
100	0.4
110	0.4
120	0.4
130	0.4
140	0.4
150	0.5
160	0.5
180	0.5
200	0.5
225	0.6
250	0.6

Destination

S - flue ducts (gas, oil)

D* - smoke ducts from pellets burning devices

Table of layouts and sizes

Diameter DN	Lr	Dz	Dw	Dk	s
60	188	60.2	59.4	60.5	0.4
80	250	80.0	79.2	81.0	
100	315	100.7	99.9	101.7	
110	350	111.8	111.0	112.8	
120	385	122.9	122.1	123.9	
130	415	132.5	131.7	133.5	
140	440	140.5	139.7	141.5	
150	475	151.7	150.7	152.7	0.5
160	505	161.2	160.2	162.2	
180	570	181.9	180.9	182.9	
200	630	201.0	200.0	202.0	
225	710	226.6	225.4	227.6	0.6
250	790	252.1	250.9	253.1	

Measurments

Lr - metal sheet layout [mm]±0.1

Dz - outer diameter of pipe [mm]±0.1

Dw - inner diameter of pipe [mm]±0.1

Dk - inner diameter of bell [mm]±0.1

s - metal sheet thickness [mm]

Example application of elements

I.



Fume exhaust through an existing chimney with chimney liner
Air for combustion process supplied from the boiler room

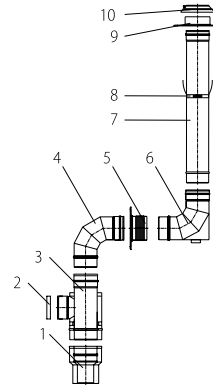
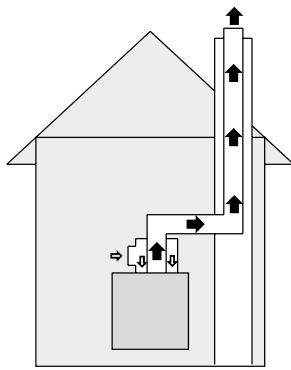

No	Denotation
1	RDD60/80/100/125-KSP-X
2	ZTS80-KSP-X
3	TRD80/125/90-DB-KSP-X
4	KS80/90-KS-X
5	ROZ80-H17
6	KSW80/90-KS-X
7	RP80/1000-KS-X
8	OU80-X
9	PD80-X
10	KPD80-X

II.



Fume exhaust through an existing chimney with chimney liner
Air for combustion process supplied through a pipe from outside the building

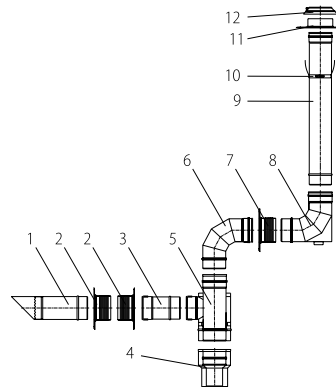
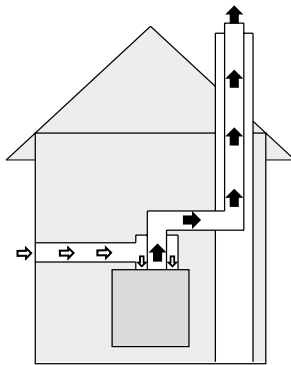

No	Denotation
1	WB125/500-X
2	ROZ125-H17
3	RP125/250-X
4	RDD60/80/100/125-KSP-X
5	TRD80/125/90-DB-KSP-X
6	KS80/90-KS-X
7	ROZ80-H17
8	KSW80/90-KS-X
9	RP80/1000-KS-X
10	OU80-X
11	PD80-X
12	KPD80-X

III.



Fume exhaust through an existing chimney with chimney liner
Air for combustion process supplied through an existing chimney using space between chimney and chimney liner

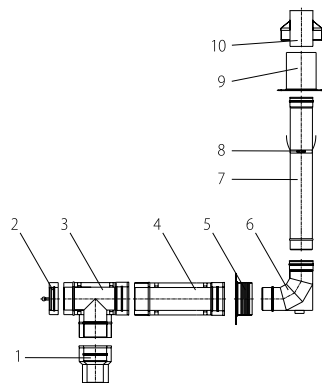
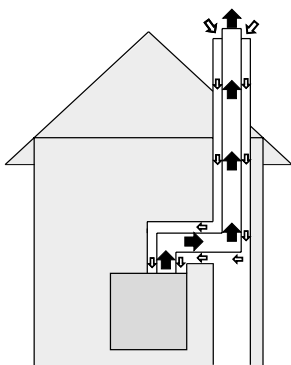

No	Denotation
1	RDD60/80/100/125-KSP-X
2	MSD80/125-KSP-X
3	TRD80/125/90-KSP-X
4	RPD80/125/500-KSP-X
5	ROZ125-H17
6	KSW80/90-KS-X
7	RP80/1000-KS-X
8	OU80-X
9	PDP80-KS-X
10	USD80/125-KSP-X

IV.



Fume exhaust through inner pipe of the concentric chimney
Air for combustion process supplied through outer pipe of concentric chimney

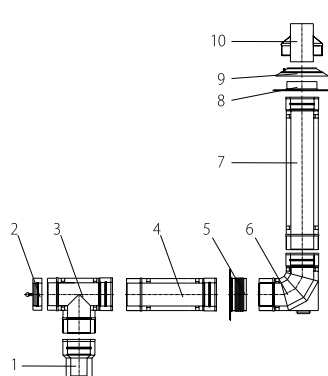
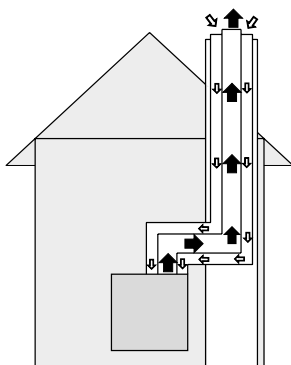

No	Denotation
1	RDD80/60-KSP-X
2	MSD80/125-KSP-X
3	TRD80/125/90-KSP-X
4	RPD80/125/500-KSP-X
5	ROZ125-H17
6	KSDW80/125/90-KSP-X
7	RPD80/125/1000-KSP-X
8	PDI25-KSP-X
9	KPD125-KSP-X
10	USD80/125-KSP-X

**SINGLE WALLED FLUE SYSTEM <SKS-X>
DOUBLE-WALLED AIR-FLUE SYSTEM <SKSP-X>**

V.

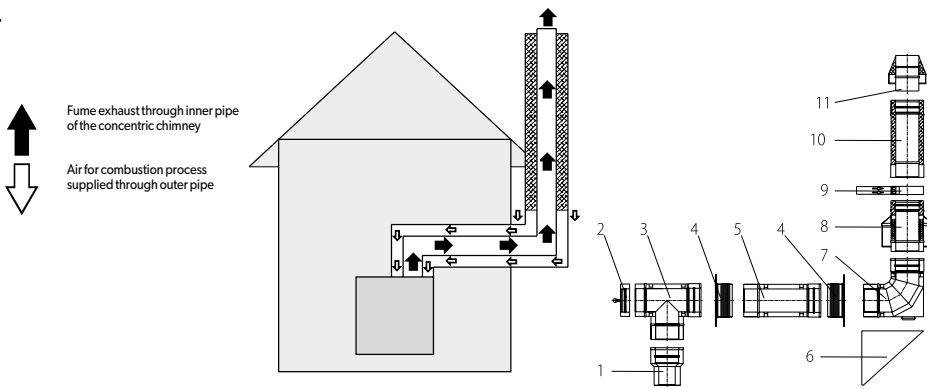

No	Denotation
1	RDD60/80/100/125-KSP-X4
2	MSD80/125-KSP-X4
3	TRD80/125/90-KSP-X4
4	ROZ125-CH
5	RPD80/125/500-KSP-X4
6	KWD125-X-60
7	KSDW80/125/90-KSP-X4
8	RP80/125-DB-KSP-X4
9	OMD-III25-X
10	RPD80/125/1000-KS-X4-IZ
11	USD80/125-X4-IZ

VI.

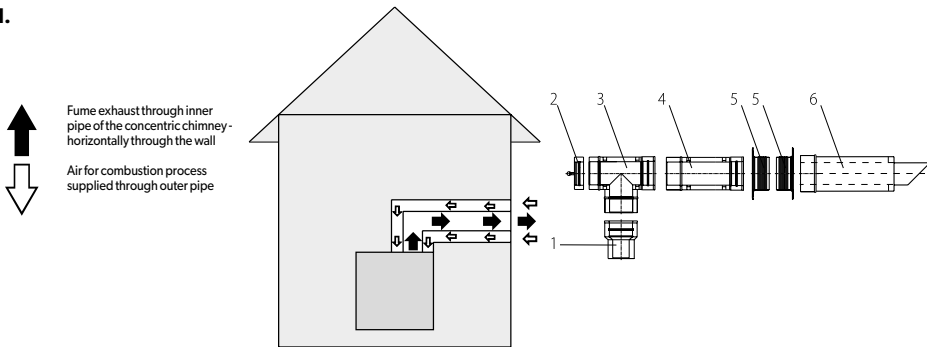

No	Denotation
1	RDD60/80/100/125-KSP-X4
2	MSD80/125-KSP-X4
3	TRD80/125/90-KSP-X4
4	RPD80/125-KSP-X4
5	ROZ125-CH
6	WBD80/125-KSP-X4

VII.

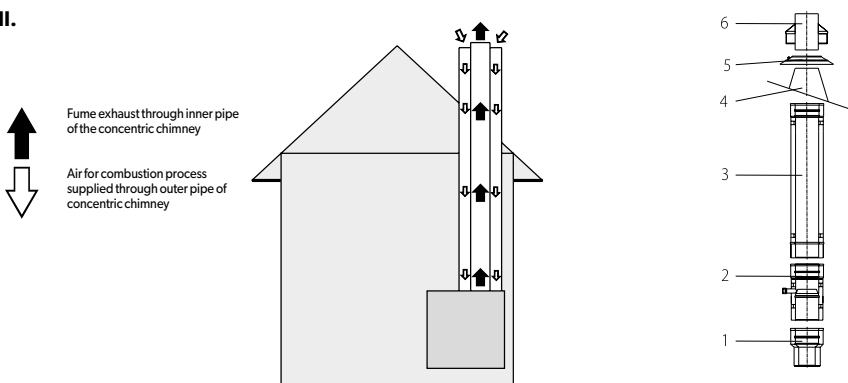

No	Denotation
1	RDD60/80/100/125-KSP-X4
2	MSPD80/125-KSP-X4
3	RPD80/125/1000-KSP-X4
4	PKD125/10-X
5	KPD125-X
6	USD80/125-KSP-X4

VIII.

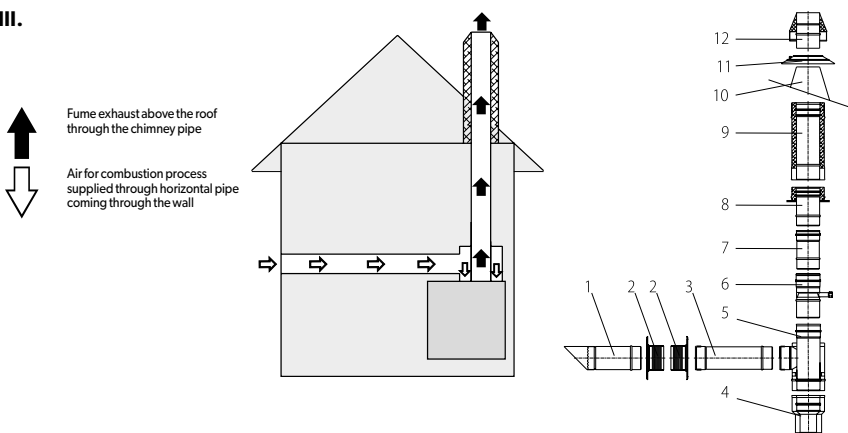

No	Denotation
1	WB125/500-X4
2	ROZ125-CH
3	RP125/250-X4
4	RDD60/80/100/125-KSP-X4
5	TRD80/125/90-DB-KSP-X4
6	MSP80-KS-X4
7	RP80/500-KS-X4
8	PJD80/125-KS-X4-IZ
9	RPD80/125/1000-KS-X4-IZ
10	PKD125/10-X
11	KPD125-X
12	USD80/125-X4-IZ

Bell joint pipe connection

Individual elements of the chimney system are being joint by the way of pushing one part of the element - a spigot, into the other press-formed part of the element - a bell. Thanks to this type of pipe joining, chimney is characterized by very tight and stiff construction. It also allows proper flow of condensate, along the walls of the chimney. Usage of a special seal made of silicone, which is applied in the middle of the bell, secures tightness of the system by positive pressure of fumes up to 200Pa.

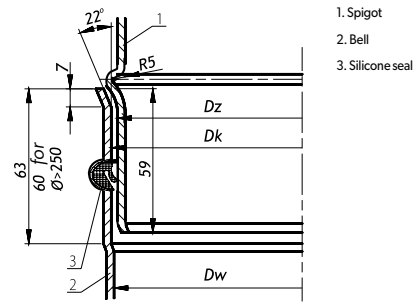
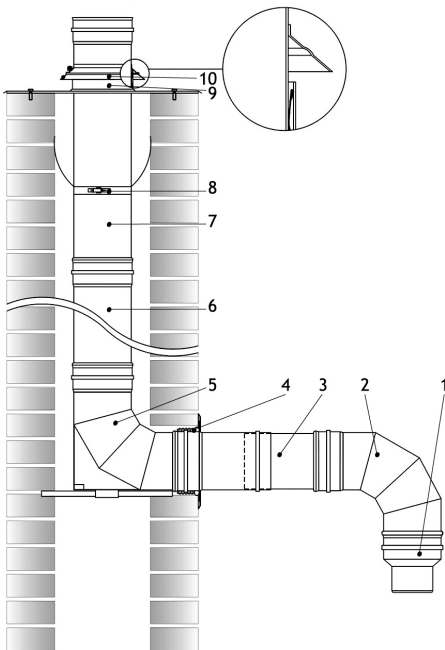

Fig. Method of joining single-walled pipe elements.

Model application of elements: SKS-X



No	Name	Denotation
1	Reducer (adaptor)	RD80/60-KS-X4
2	Solid elbow 90°	KS80/90-KS-X4
3	Telescopic pipe	RT80/2X250-KS-X4
4	Rosette	ROZ80-CH
5	Solid elbow 90° with support	KSW80/90-KS-X4
6	Straight pipe 250 mm	RP80/250-KS-X4
7	Straight pipe 1000 mm	RP80/1000-KS-X4
8	Stabilizing brackets	OU80-X
9	Roof plate	PD80-X
10	Rain collar	KPD80-X

Fig. Example of a flue chimney construction - vertical fume exhaust.

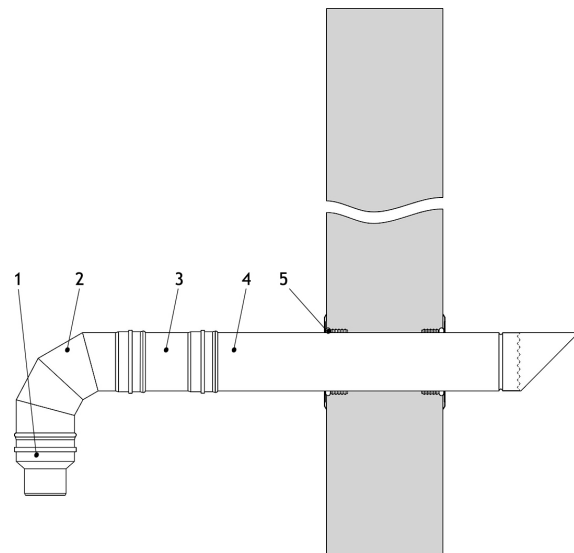

No	Name	Denotation
1	Reducer (adaptor)	RD80/60-KS-X4
2	Solid elbow 90°	KS80/90-KS-X4
3	Straight pipe 250 mm	RP80/250-KS-X4
4	Horizontal terminal 1000 mm	WB80/1000-KS-X4
5	Rosette	ROZ80-CH

Fig. Example of a flue chimney construction - horizontal fume exhaust (through the wall)

1. STRAIGHT PIPE RP-KS-X

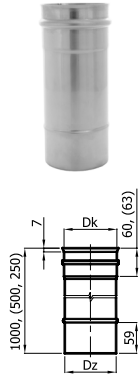

Diameter DN	ø60	ø80	ø100	ø110	ø120	ø130	ø140	ø150	ø160	ø180	ø200	ø225	ø250	for s=0.4±0.6
Dz	60.2	80.0	100.7	111.8	122.9	132.5	140.5	151.7	161.2	181.9	201.0	226.6	252.1	
Dk	60.5	81.0	101.7	112.8	123.9	133.5	141.5	152.7	162.2	182.9	202.0	227.6	253.1	
Weight [kg]	0.60	0.80	1.00	1.10	1.20	1.30	1.40	1.90	2.00	2.30	2.50	3.40	3.80	

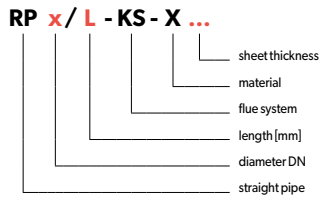

Destination	S	S - flue ducts (gas, oil)
	*	D - smoke ducts
Material	X	X - stainless steel 1.4301
Sheet thickness s	4	4 - sheet thickness 0.4 mm
	5	5 - sheet thickness 0.5 mm
	6	6 - sheet thickness 0.6 mm

* from pellet stoves

2. STRAIGHT PIPE WITH MEASURING OUTLET 1/4" ROP-KS-X

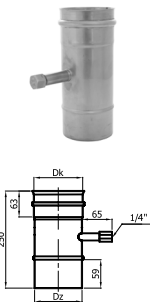

Diameter DN	ø60	ø80	ø100	ø110	ø120	ø130	ø140	ø150	ø160	ø180	ø200	ø225	ø250	for s=0.4±0.6
Dz	60.2	80.0	100.7	111.8	122.9	132.5	140.5	151.7	161.2	181.9	201.0	226.7	252.1	
Dk	60.5	81.0	101.7	112.8	123.9	133.5	141.5	152.7	162.2	182.9	202.0	227.6	253.1	
Weight [kg]	0.25	0.30	0.35	0.40	0.40	0.45	0.45	0.60	0.60	0.70	0.75	0.85	1.00	

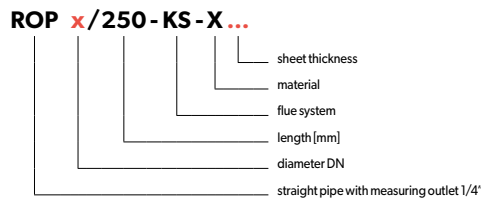

Destination	S	S - flue ducts (gas, oil)
	*	D - smoke ducts
Material	X	X - stainless steel 1.4301
Sheet thickness s	4	4 - sheet thickness 0.4 mm
	5	5 - sheet thickness 0.5 mm
	6	6 - sheet thickness 0.6 mm

* from pellet stoves

3. TELESCOPIC PIPE RT-KS-X

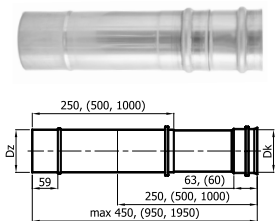

Diameter DN	ø60	ø80	ø100	ø110	ø120	ø130	ø140	ø150	ø160	ø180	ø200	ø225	ø250	for s=0.4±0.6 L=2x250
Dz	60.2	80.0	100.7	111.8	122.9	132.5	140.5	151.7	161.2	181.9	201.0	226.7	252.1	
Dk	60.5	81.0	101.7	112.8	123.9	133.5	141.5	152.7	162.2	182.9	202.0	227.6	253.1	
Weight [kg]	0.30	0.40	0.50	0.55	0.60	0.65	0.70	0.95	1.00	1.15	1.25	1.70	1.90	

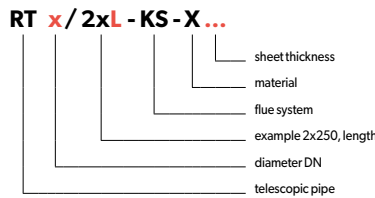

Destination	S	S - flue ducts (gas, oil)
	*	D - smoke ducts
Material	X	X - stainless steel 1.4301
Sheet thickness s	4	4 - sheet thickness 0.4 mm
	5	5 - sheet thickness 0.5 mm
	6	6 - sheet thickness 0.6 mm

* from pellet stoves

4. LATERAL OUTLET WITH WIRE MESH WB-KS-X

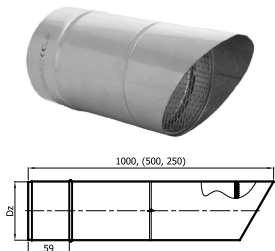

Diameter DN	ø60	ø80	ø100	ø110	ø120	ø130	ø140	ø150	ø160	ø180	ø200	ø225	ø250	for s=0.4±0.6
Dz	60.2	80.0	100.7	111.8	122.9	132.5	140.5	151.7	161.2	181.9	201.0	226.7	252.1	
Weight [kg]	0.60	0.80	1.00	1.10	1.20	1.30	1.40	1.90	2.00	2.30	2.50	3.00	3.30	

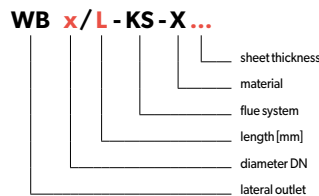

Destination	S	S - flue ducts (gas, oil)
	*	D - smoke ducts
Material	X	X - stainless steel 1.4301
Sheet thickness s	4	4 - sheet thickness 0.4 mm
	5	5 - sheet thickness 0.5 mm
	6	6 - sheet thickness 0.6 mm

* from pellet stoves

5. REDUCER RD-KS-X

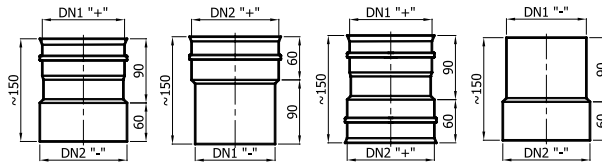

ex. RD+80/-60-KS

„+“ bell
„-“ spigot

Diameter DN	ø60	ø80	ø100	ø110	ø120	ø130	ø140	ø150	ø160	ø180	ø200	ø225	ø250	for s=0,4≠0,6
Weight [kg]	0.10	0.15	0.19	0.21	0.23	0.25	0.32	0.34	0.36	0.41	0.45	0.51	0.57	

RD ±x / ±y -KS -X ...

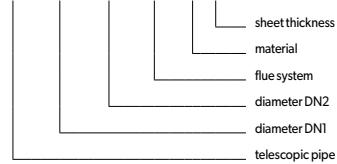

Destination	S	S - flue ducts (gas, oil)
	*	D - smoke ducts
Material	X	X - stainless steel 1.4301
Sheet thickness s	4	4 - sheet thickness 0.4 mm
	5	5 - sheet thickness 0.5 mm
	6	6 - sheet thickness 0.6 mm

* from pellet stoves

6. TEE 87° TR/90-KS, TEE 93° TR/90-KS-X-TURBO

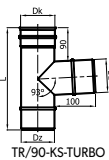
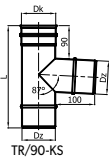

Diameter DN	ø60	ø80	ø100	ø110	ø120	ø130	ø140	ø150	ø160	ø180	ø200	ø225	ø250	for s=0,4≠0,6
Dz	60.2	80.0	100.7	111.8	122.9	132.5	140.5	151.7	161.2	181.9	201.0	226.7	252.1	
Dk	60.5	81.0	101.7	112.8	123.9	133.5	141.5	152.7	162.2	182.9	202.0	227.6	253.1	
L [mm]	240	260	280	290	300	310	320	330	340	360	380	405	430	
Weight [kg]	0.20	0.30	0.40	0.45	0.50	0.55	0.60	0.80	0.90	1.10	1.20	1.75	2.00	

TR x / 90 -KS -X ... -TURBO

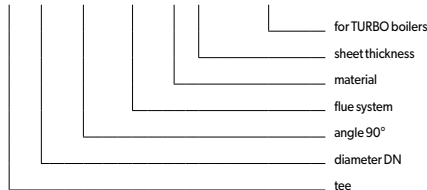

Destination	S	S - flue ducts (gas, oil)
	*	D - smoke ducts
Material	X	X - stainless steel 1.4301
Sheet thickness s	4	4 - sheet thickness 0.4 mm
	5	5 - sheet thickness 0.5 mm
	6	6 - sheet thickness 0.6 mm

* from pellet stoves

7. CHIMNEY CAP DK-KS-X

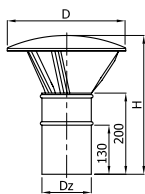

Diameter DN	ø60	ø80	ø100	ø110	ø120	ø130	ø140	ø150	ø160	ø180	ø200	for s=0,4≠0,6
Dz	59.0	78.7	99.4	110.5	121.7	131.2	139.0	150.1	159.7	180.4	199.5	
D	160	160	220	220	250	250	290	290	290	290	350	
H	315	315	330	335	340	355	360	365	365	365	400	
Weight [kg]	0.40	0.45	0.50	0.55	0.60	0.65	0.70	0.85	0.90	1.00	1.10	

DK x -KS -X ...

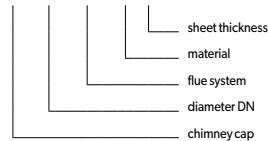

Destination	S	S - flue ducts (gas, oil)
	*	D - smoke ducts
Material	X	X - stainless steel 1.4301
Sheet thickness s	4	4 - sheet thickness 0.4 mm
	5	5 - sheet thickness 0.5 mm
	6	6 - sheet thickness 0.6 mm

* from pellet stoves

8. CHIMNEY CAP DK-KS-X

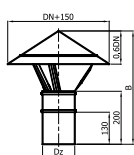

Diameter DN	ø225	ø250	for s=0,6
Dz	224.5	250.2	
B	470	500	
Weight [kg]	1.75	2.00	

DK x -KS -X ...

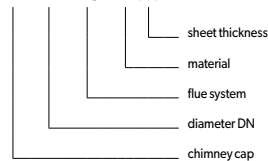

Destination	S	S - flue ducts (gas, oil)
	*	D - smoke ducts
Material	X	X - stainless steel 1.4301
Sheet thickness s	4	4 - sheet thickness 0.4 mm
	5	5 - sheet thickness 0.5 mm
	6	6 - sheet thickness 0.6 mm

* from pellet stoves

9. ROOF PLATE-LENGTHENED PDP-KS

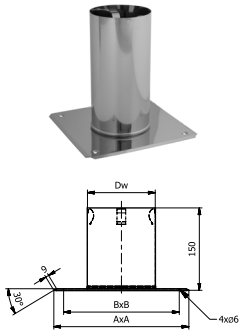

Diameter DN	ø60	ø80	ø100	ø110	ø120	ø130	ø140	ø150	ø160	ø180	ø200	ø225	ø250	for s=0,4≠0,6
Dw [mm]	99.8	125.2	150.7	160.3	181.0	200.1	225.5	225.5	250.9	300.3	300.3	324.2	324.2	
A [mm]	250	250	300	300	300	300	350	350	400	450	450	450	450	
B [mm]	210	210	260	260	260	290	310	310	360	410	410	410	410	
Weight [kg]	0.60	0.65	0.80	0.80	0.85	0.95	1.20	1.25	1.45	1.65	1.70	1.85	1.90	

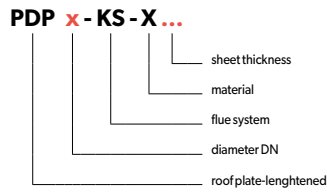

Destination	S	S - flue ducts (gas, oil)
Material	X	X - stainless steel 1.4301
Sheet thickness s	4	4 - sheet thickness 0.4 mm
	5	5 - sheet thickness 0.5 mm
	6	6 - sheet thickness 0.6 mm

10. FORCE-IN MOUNTING BASE PRT-KS

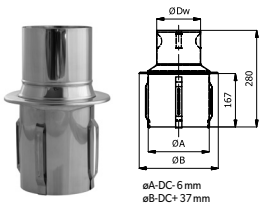

Diameter DN	ø60	ø80	ø100	ø110	ø120	ø130	ø140	ø150	ø160	ø180	ø200	ø225	ø250	for s=0,4≠0,6
øDw [mm]	99.8	125.2	150.7	160.3	181.0	200.1	225.5	225.5	250.9	300.3	324.2	324.2	324.2	
Weight [kg]	0.60	0.65	0.80	0.80	0.85	0.95	1.20	1.25	1.45	1.65	1.70	1.85	1.90	

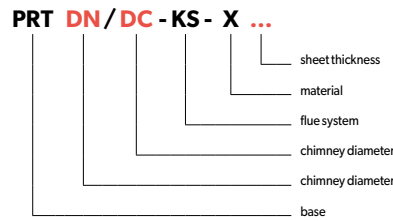

Destination	S	S - flue ducts (gas, oil)
Material	X	X - stainless steel 1.4301
Sheet thickness s	4	4 - sheet thickness 0.4 mm
	5	5 - sheet thickness 0.5 mm
	6	6 - sheet thickness 0.6 mm

11. TEE PLUG ZTR-KS

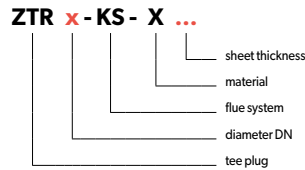
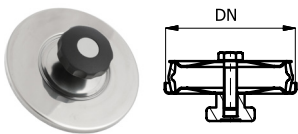

Destination	S	S - flue ducts (gas, oil)
Material	X	X - stainless steel 1.4301
Sheet thickness s	4	4 - sheet thickness 0.4 mm
	5	5 - sheet thickness 0.5 mm
	6	6 - sheet thickness 0.6 mm

Diameter DN	ø60	ø80	for s=0,4≠0,6
Weight [kg]	0.16	0.18	

12. RAIN COLLAR WITH AIR INLET KPD-KS

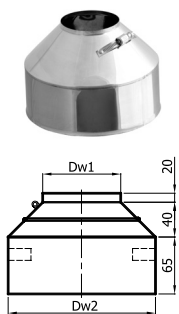

Diameter DN	ø60	ø80	ø100	ø110	ø120	ø130	ø140	ø150	ø160	ø180	ø200	ø225	ø250	for s=0,4≠0,6
Dw1	60.1	80.1	100.8	111.9	123.0	132.6	140.6	151.8	161.3	182.0	201.1	226.7	252.2	
Dw2	160	180	210	220	240	260	280	280	310	360	360	410	140	
Weight [kg]	0.20	0.25	0.25	0.30	0.30	0.35	0.45	0.45	0.50	0.55	0.55	0.60	0.60	

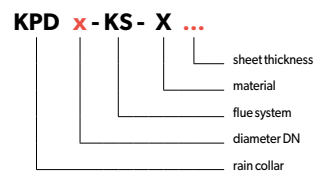

Destination	S	S - flue ducts (gas, oil)
Material	X	X - stainless steel 1.4301
Sheet thickness s	4	4 - sheet thickness 0.4 mm
	5	5 - sheet thickness 0.5 mm
	6	6 - sheet thickness 0.6 mm

13. CONDENSATE BOWL/PLUG MS-KS-X

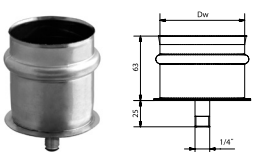

Diameter DN	ø60	ø80	ø90	ø100	ø110	ø120	ø130	ø140	ø150	ø160	ø180	ø200	ø225	ø250	for s=0,4≠0,6
Dw [mm]	59.6	79.2	99.9	111.0	122.1	131.7	139.7	150.7	160.2	180.9	200.0	225.4	250.9	251.0	
Weight [kg]	0.16	0.18	0.20	0.21	0.23	0.24	0.26	0.30	0.33	0.35	0.40	0.45	0.50	0.60	

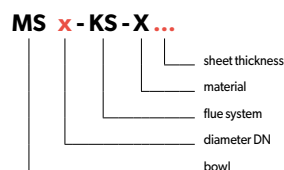

Destination	S	S - flue ducts (gas, oil)
	*	D - smoke ducts
Material	X	X - stainless steel 1.4301
Sheet thickness s	4	4 - sheet thickness 0.4 mm
	5	5 - sheet thickness 0.5 mm
	6	6 - sheet thickness 0.6 mm

* from pellet stoves

14. CONDENSATE BOWL/PLUG ZT-KS-X

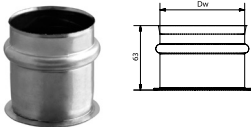

Diameter DN	ø60	ø80	ø90	ø100	ø110	ø120	ø130	ø140	ø150	ø160	ø180	ø200	ø225	ø250	for s=0.4≠0.6
Dw [mm]	59.6	79.2	99.9	111.0	122.1	131.7	139.7	150.7	160.2	180.9	200.0	225.4	250.9	251.0	
Weight [kg]	0.14	0.16	0.18	0.19	0.21	0.22	0.24	0.28	0.31	0.32	0.38	0.43	0.48	0.58	

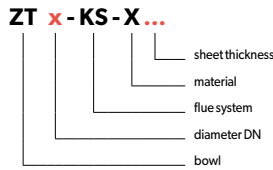

Destination	S	S - flue ducts (gas, oil)
	*	D - smoke ducts
Material	X	X - stainless steel 1.4301
	4	4 - sheet thickness 0.4 mm
Sheet thickness s	5	5 - sheet thickness 0.5 mm
	6	6 - sheet thickness 0.6 mm

* from pellet stoves

15. VERTICAL BOWL MSP-KS-X



Diameter DN	ø60	ø80	ø100	ø110	ø120	ø130	ø140	ø150	ø160	ø180	ø200	ø225	ø250	for s=0.4≠0.6
Dz	60.2	80.0	100.7	111.8	122.9	132.5	140.5	151.7	161.2	181.9	201.0	226.6	252.1	
Dk	60.5	81.0	101.7	112.8	123.9	133.5	141.5	152.7	162.2	182.9	202.0	227.6	253.1	
Weight [kg]	0.25	0.30	0.35	0.40	0.40	0.45	0.45	0.60	0.60	0.70	0.75	0.85	1.00	

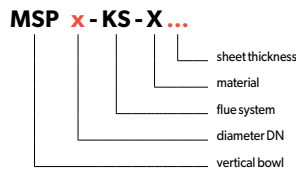

Destination	S	S - flue ducts (gas, oil)
	*	D - smoke ducts
Material	X	X - stainless steel 1.4301
	4	4 - sheet thickness 0.4 mm
Sheet thickness s	5	5 - sheet thickness 0.5 mm
	6	6 - sheet thickness 0.6 mm

* from pellet stoves

16. VERTICAL BOWL MSP-X

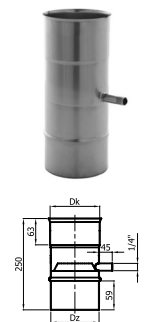

Diameter DN	ø100	ø125	ø150	ø160	ø180	ø200	ø225	ø250	ø300	ø350	for s=0.4≠0.6
Dz	100.8	124.6	151.9	161.4	182.1	201.2	226.7	252.2	301.6	350.9	
Dk	101.8	125.6	152.9	162.4	183.1	202.2	227.7	253.2	303.1	352.4	
Weight [kg]	0.45	0.50	0.70	0.75	0.85	0.90	1.00	1.10	1.30	1.50	

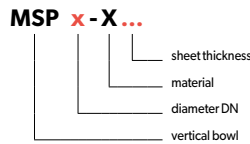

Destination	S	S - flue ducts (gas, oil)
	*	D - smoke ducts
Material	X	X - stainless steel 1.4301
	4	4 - sheet thickness 0.4 mm
Sheet thickness s	5	5 - sheet thickness 0.5 mm
	6	6 - sheet thickness 0.6 mm

* from pellet stoves

17. SOLID ELBOW 87° KS/90-KS, SOLID ELBOW 93° KS/90-KS-X-TURBO

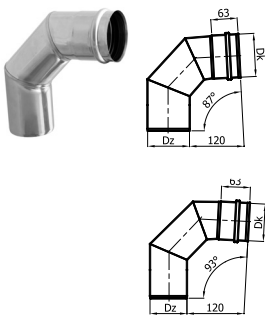

Diameter DN	ø60	ø80	ø100	ø110	ø120	ø130	ø140	ø150	ø160	ø180	ø200	ø225	ø250	for s=0.4≠0.6
Dz [mm]	60.2	80.0	100.7	111.8	122.9	132.5	140.5	151.7	161.2	181.9	201.0	226.6	252.1	
Dk [mm]	60.5	81.0	101.7	112.8	123.9	133.5	141.5	152.7	162.2	182.9	202.0	227.6	253.1	
Weight [kg]	0.19	0.24	0.36	0.40	0.44	0.48	0.60	0.70	0.85	0.90	1.05	1.40	1.85	

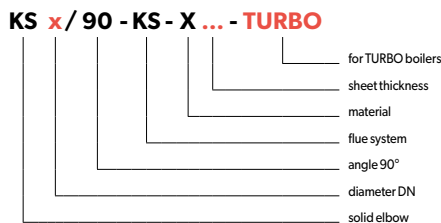

Destination	S	S - flue ducts (gas, oil)
	*	D - smoke ducts
Material	X	X - stainless steel 1.4301
	4	4 - sheet thickness 0.4 mm
Sheet thickness s	5	5 - sheet thickness 0.5 mm
	6	6 - sheet thickness 0.6 mm

* from pellet stoves

18. SOLID ELBOW 87° WITH SUPPORT KSW/90-KS-X

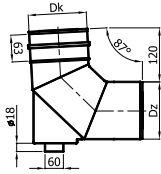

Diameter DN	ø60	ø80	ø100	ø110	ø120	ø130	ø140	ø150	ø160	ø180	ø200	ø225	ø250	for s=0,4#0,6
Dz [mm]	60.2	80.0	100.7	111.8	122.9	132.5	140.5	151.7	161.2	181.9	201.0	226.6	252.1	
Dk [mm]	60.5	81.0	101.7	112.8	123.9	133.5	141.5	152.7	162.2	182.9	202.0	227.6	253.1	
Weight [kg]	0.19	0.24	0.36	0.40	0.44	0.48	0.60	0.70	0.85	0.90	1.05	1.40	1.85	

KS x / 90 - KS - X ...

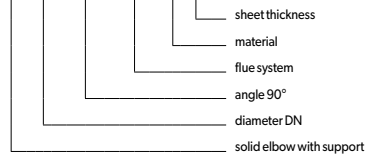

Destination	S	S - flue ducts (gas, oil)
	*	D - smoke ducts
Material	X	X - stainless steel 1.4301
Sheet thickness s	4	4 - sheet thickness 0.4 mm
	5	5 - sheet thickness 0.5 mm
	6	6 - sheet thickness 0.6 mm

* from pellet stoves

19. SOLID ELBOW 45° KS/45-KS-X

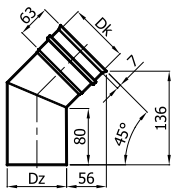

Diameter DN	ø60	ø80	ø100	ø110	ø120	ø130	ø140	ø150	ø160	ø180	ø200	ø225	ø250	for s=0,4#0,6
Dz	60.2	80.0	100.7	111.8	122.9	132.5	140.5	151.7	161.2	181.9	201.0	226.6	252.1	
Dk	60.5	81.0	101.7	112.8	123.9	133.5	141.5	152.7	162.2	182.9	202.0	227.6	253.1	
Weight [kg]	0.12	0.16	0.24	0.24	0.28	0.32	0.40	0.42	0.50	0.60	0.66	0.95	1.10	

KS x / 45 - KS - X ...



Destination	S	S - flue ducts (gas, oil)
	*	D - smoke ducts
Material	X	X - stainless steel 1.4301
Sheet thickness s	4	4 - sheet thickness 0.4 mm
	5	5 - sheet thickness 0.5 mm
	6	6 - sheet thickness 0.6 mm

* from pellet stoves